

MINORCA CTFS

WALL-HUNG GAS BOILER WITH SEALED CHAMBER AND FORCED DRAUGHT WITH INSTANT DHW PRODUCTION



Available in the following models:



- ▶ **Standard ambient temperature probe**
- ▶ **Ultra-compact size**
- ▶ **LCD user interface with diagnostics**
- ▶ **Primary aluminium heat exchanger**
- ▶ **CH water flow rate electronic control**
- ▶ **Standard ambient temperature probe**
- ▶ **Ambient temperature can be set from the boiler if an ambient probe is installed**
-) Stainless steel plate DHW heat exchanger
-) Exclusive compact version circulation pump with integrated air purging device
-) NTC temperature probe on flow and return lines
-) LCD interface to view CH flow water temperature, DHW outlet temperature, failure codes, CH setting, DHW setting and operating status setting
-) Hydraulic unit in composite material
-) Heating expansion vessel - 6 litres

Model	Gas type	Code	Heat output (kW)		W x H x D (mm)	Gross weight (Kg)
			Nominal Pn	DHW (ΔT 30°C)		
CTFS 9	NATURAL GAS	CMExx2CA09	9,3	7,0	400x700x250	25,00
	LPG	CMExx3CA09				
CTFS 11	NATURAL GAS	CMExx2CA11	11,1	7,0	400x700x250	25,00
	LPG	CMExx3CA11				
CTFS 13	NATURAL GAS	CMExx2CA13	13,0	7,0	400x700x250	25,00
	LPG	CMExx3CA13				
CTFS 15	NATURAL GAS	CMExx2CA15	15,1	7,0	400x700x250	25,00
	LPG	CMExx3CA15				
CTFS 18	NATURAL GAS	CMExx2CA18	18,6	7,0	400x700x250	25,50
	LPG	CMExx3CA18				
CTFS 24	NATURAL GAS	CMExx2CA24	23,3	11,5	400x700x250	25,50
	LPG	CMExx3CA24				

DIMENSIONS AND CONNECTION CENTRE DISTANCES

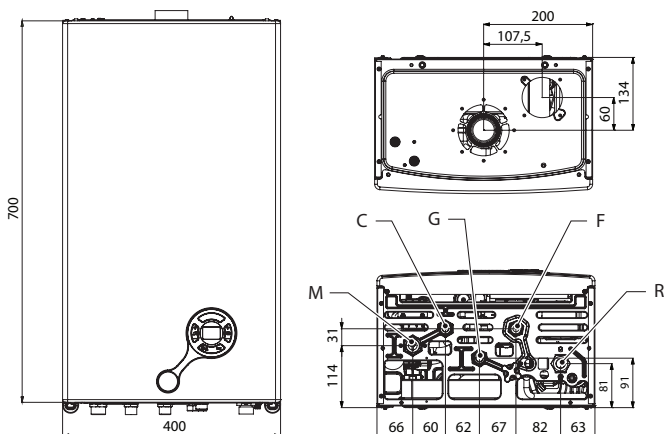

M CH system flow (3/4")
C DHW outlet (1 1/2")
G Gas inlet (1/2")

F Cold water inlet (1/2")
R CH system return (3/4")





Technical specifications	um	CTFS 9	CTFS 11	CTFS 13	CTFS 15	CTFS 18	CTFS 24
Nominal heat input (Qn)	kW	10,4	12,3	14,2	16,4	20,0	25,5
Nominal heat output (80-60°C) (Pn)	kW	9,3	11,1	13,0	15,1	18,6	23,3
Useful efficiency at nominal input (80-60°C)	%	89,2	90,2	91,2	91,8	93,2	91,2
Useful efficiency at 30% (30°C return)	%	86,2	86,9	87,6	87,7	88,2	87,4
Heating circuit working pressure (min-max)	bar	0,5-3,0	0,5-3,0	0,5-3,0	0,5-3,0	0,5-3,0	0,5-3,0
CH temperature setting range	°C	35-78	35-78	35-78	35-78	35-78	35-78
Heating expansion vessel capacity	l	6	6	6	6	6	6
DHW circuit working pressure (min-max)	bar	0,5-6,0	0,5-6,0	0,5-6,0	0,5-6,0	0,5-6,0	0,5-6,0
Specific DHW flow ΔT=30K	l/min	9,5	9,5	9,5	9,5	9,5	11,7
DHW temperature range	°C	35-57	35-57	35-57	35-57	35-57	35-57
NOx emission class	-	3	3	3	3	3	3
Power supply voltage/frequency	V/Hz	230/50	230/50	230/50	230/50	230/50	230/50
Maximum power consumption	W	102	102	102	102	102	102
Electric protection rating	IP	X4D	X4D	X4D	X4D	X4D	X4D

For other technical specifications, see from page 161 - Maximum length of flue gas venting, see page 194

Item	Description	Code
	Compact wall pipe cover	OCOPETUB00
	Hydrocyclonic and magnetic filter 3/4"(3,000 l/hour)	OFILTIMP00
	A kit, coaxial Ø100/60 L= 1m (for TFS boilers)	OKITCONC00
	Dirt separator kit	OKITDEFA00
	Flow - return cold water 90° taps kit	OKITIDBA11
	Basic hydr. kit for basic compact unit	OKITIDBA13

Item	Description	Code
	Plus hydr. kit for basic compact unit	OKITIDBA14
	Tap kit with filter	OKITRUBI04
	Protective liquid for domestic mixed metal plants (0.5 l bottle)	OPROTIMP00
	Universal mild cleaning product (0.5 l bottle)	OPROTIMP01
	External probe (60x45x31 mm)	OSONDAES01

For other accessories, see from page 193

