

## Flexible fire resistant acoustic mastic



Mixed services



Construction joints



Metallic Pipes

### APPLICATIONS

- Metallic Pipes - 159mm (6")
- Cables trays - 450 x 50mm (18" x 2")
- Cable Bunches - 80mm (3")
- Linear Joints - Flexible & Rigid Construction Elements
- Joints between FCPS Coated Panel System

### ADVANTAGES

- Water based
- Low VOC
- Movement capability  $\pm 20\%$
- Excellent acoustic properties
- Approved for infinite linear gap length
- Halogen & solvent free
- Paintable

### APPROVALS



ETA 14-0378  
ETA 14-0379  
1121-CPR-JA5044

### British Standard

**BS 476 - 20**

**BS EN ISO 10140-3:1995**

**BS EN 1026**

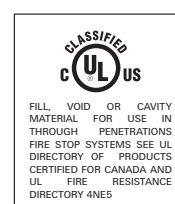

Approved CF 5034

The laboratory measurement of airborne sound insulation of building elements

Air Permeability Test Method



### BUILDING MATERIALS

#### Suitable for:

- Flexible wall constructions
- Rigid floor and wall constructions
- Masonry
- Concrete
- Timber
- Steel
- FCPS System

### DESCRIPTION

- fischer FiAM is a one part water based acrylic emulsion that can provide up to 5 hours fire resistance when used in construction joints and services in both vertical and horizontal applications. When exposed to fire, it reacts to form a highly insulative char that slows down heat transfer, and provides a barrier to fire seal.
- Tested to BS EN1366-3 & 4, UL 2079 and BS476-20 the FiAM is also ETA approved and CE Marked. Formulated to be halogen and solvent free the FiAM exhibits excellent slump characteristics and has been designed to maintain the sound reduction index of a structure.
- Suitable compatibility in a variety of materials, such as timber, steel, concrete, drywall and brick/block work, and is utilised within the fischer FCPS Coated Panel System, which is design to seal large openings in fire rated floors & walls.

### INSTALLATION

**Note: Firestop material must be installed in accordance with detailed instructions or the approved system.**

- 1 Clean all contact surfaces so they are free from loose debris and contaminants.
- 2 Install the required backing material as per the detailed instructions or approved system.
- 3 For best application results - fischer FiAM should be at room temperature.
- 4 Apply fischer FiAM to required parameters as per detailed instruction or approved system making sure that it is in contact with all surfaces to provide maximum adhesion.
- 5 Tool sealant to a defect free finish using a wetted trowel or putty knife.
- 6 Clean all equipment with water immediately after use.

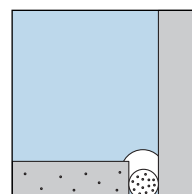
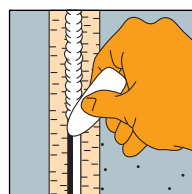
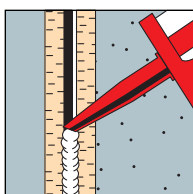
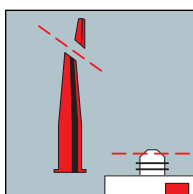

## SPECIFICATIONS

Description	Order No.	Size [ml]	Qty. Per Box	Suitable for use with
<b>FiAM 310</b>	53011	310	25	-
<b>FiAM 600</b>	56006	600	25	-
<b>KP m2 Applicator Gun</b>	53117	-	1	FiAM 310
<b>Applicator Gun 600ml</b>	97967	-	1	FiAM 600

## TECHNICAL DATA

Chemical Base:	Water-Based Acrylic
Relative Gravity:	approx 1.6 g/cm <sup>3</sup>
Skin-forming time:	approx 10 min. at 23°C RH
Curing rate:	approx 1.5 mm per 24 hours*
Storage temperature:	+5°C to +25°C
Movement capability:	± 20%
Slump:	Nil up to 20mm
Shelf-life:	18 months (under recommended conditions)
pH Value:	8 - 9.5
Sound transmission class: (dB)	38
Yield per l/m:	1.55 yield per linear meter
Colour	White, Grey, Brown
European Technical Approval	ETA 14-0378, ETA 14-0379
CE Mark	1121-CPR-JA5044

\* dependent on substrate, air humidity and weather conditions

\*\* based on 20mm x 10mm gap using 310ml cartridge

## APPLICATION DATA

The following dimensions must be observed when using fischer FiAM

### Consumption Guide

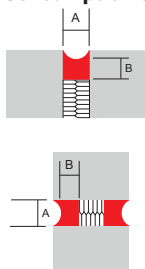

Joint Width A [mm]	Joint Depth B [mm]	Yield per Linear Metres
30	20	0.5
20	15	1.0
15	8	1.25
10	10	3.0
6	6	4.25

### Application Guide

Max Joint Width	Substrate	Fire Ratings (Minutes)	
		Integrity Rating	Insulation Rating
50	Concrete/concrete	300	300
25	Brick/concrete	240	30
50	Steel/blockwork	300	90
50	Hardwood/blockwork	60	60
25	Softwood/blockwork	30	30
20	Drywall/concrete/head detail	120	120
<b>Substrates :Drywall/Masonry/Concrete</b>			
<b>Service Type</b>		<b>Size</b>	
<b>Copper /steel /metal pipes</b>		14-159mm Diam	Up to 120 Up to 90
<b>Loaded cable tray</b>		450 x 50 (Tray) Cables to 21mm	Up to 120 Up to 90
<b>Single / bunched cables</b>		30-80mm diam. cables	Up to 90 Up to 90

## ADDITIONAL INFORMATION

Note: Please refer to SDS for further information

### Recommendations

- Can be used in conjunction with a suitable backing material as approved in detailed instruction or approved system
  - Non-flammable mineral wool (min. 60 kg/m<sup>3</sup>)
  - PE backing rod 35 kg/m<sup>3</sup>
  - fischer FireStop Foam
- Approved for infinite linear gaps & lengths

### Storage

- Storage temperatures between +5°C and +25°C
- Store away from heat sources
- Keep container closed until use
- Monitored expiry date on tube